

APPROXIMATELY 122,016 SF OF MOVE IN
READY OFFICE SPACE

ONE 60

ELGIN
STREET





ONE 60

ELGIN STREET



Today's future forward companies recognize that the dynamics that accelerate decisions, achieve innovation, or generate ideas hinge on collaboration between groups. ONE 60 Elgin Street is perfectly suited to facilitate those connections and cooperation.

PREMISE DETAILS

ONE 60 Elgin Street

- Part of the 2nd floor 8,430 sf
- All of the 3rd floor 37,871 sf
- All of the 4th floor 37,841 sf
- All of the 7th floor 37,847 sf
- Sublease terms – Lease Expiry: February 28th, 2032
- Sublease Rate – Negotiable
- Additional Rent – \$24.61 (2020 est.)

HIGHLIGHTS

- Underground parking available
- Transit stop at the door on Elgin Street
- Direct to Hwy 417 via Elgin Street or Nicholas Street
- Located on the ground floor, the Cuisine Club offers 10 food offerings in a modern, brightly lit environment the Cuisine Club restaurants: Booster Juice, Bridgehead, California Thai, The Cupcake Lounge, Gabriel Pizza, Green Rebel, Mac's Sushi, Ya Habibi, Marcello's and Brown's Social Club.
- Building amenities include: complimentary Wi-Fi, mobile charging stations, heated sidewalks, bird-safe glass
- LEED® Gold Status
- Numerous retail amenities located on the ground floor include: Vivah boutique, Rexall, LCBO, Hillary's, Circle K
- At just under 40,000 SF per floor, 160 Elgin Street is home to the largest floorplate in downtown Ottawa

ONE 60



Modern furniture can be reconfigured for Social Distancing



A/ Lobby Area B/ 3rd Floor C/ Conference Centre D/ Elevators Lobby



A



C



B



D



E

- A/ Shared Boardroom
- B/ Collaborative Work Space
- C/ Office Space
- D/ Office Space
- E/ Kitchen

ONE 60

Second Floor

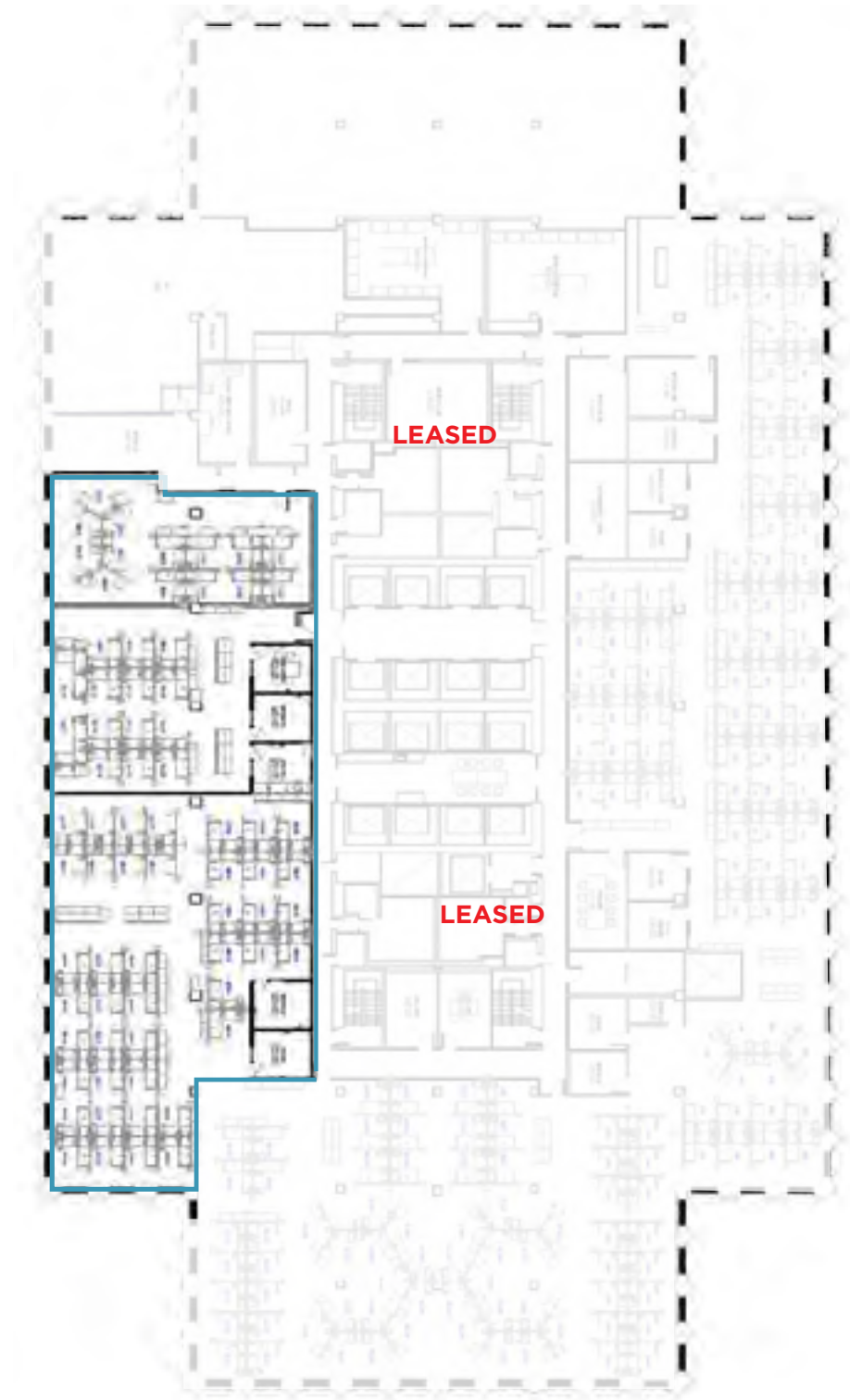

RENTABLE AREA: 2nd FLOOR 8,430 SF



Third Floor



RENTABLE AREA: 3rd FLOOR 37,871 SF



ONE 60

Fourth Floor



RENTABLE AREA: 4th FLOOR 37,841 SF



Seventh Floor

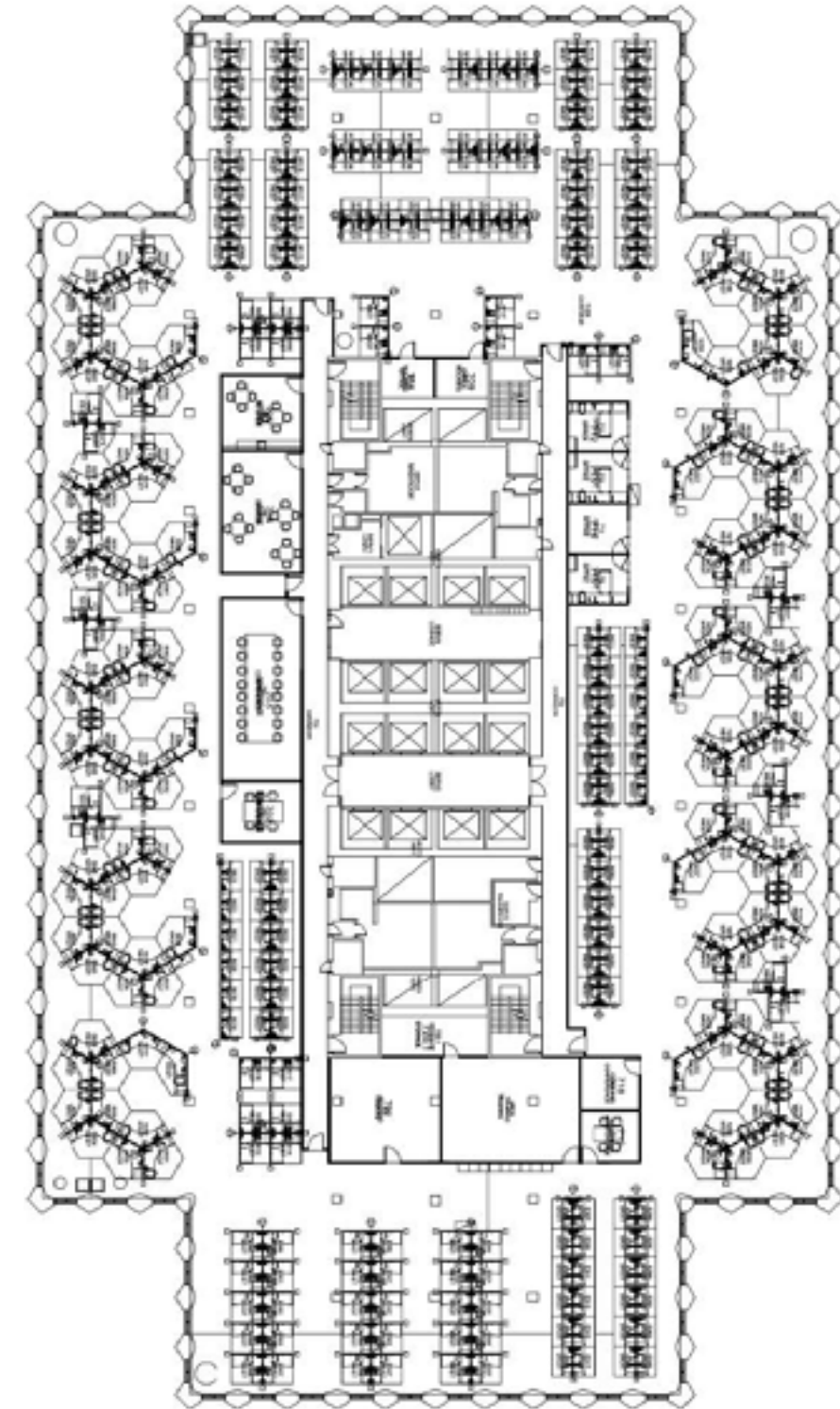

RENTABLE AREA: 7th FLOOR 37,847 SF



An aerial photograph of Ottawa, Canada, showing a dense urban landscape. The central focus is a tall, modern skyscraper with a distinctive facade of vertical, light-colored panels. To its left is a shorter, brick building with a brown roof. The surrounding area is filled with various other buildings, including older structures with gabled roofs and modern glass-fronted ones. A wide, multi-lane road with a median runs through the scene, with some snow on the ground. In the background, the city extends to the horizon under a cloudy sky.

Located in the heart
of Ottawa's unique
landscape

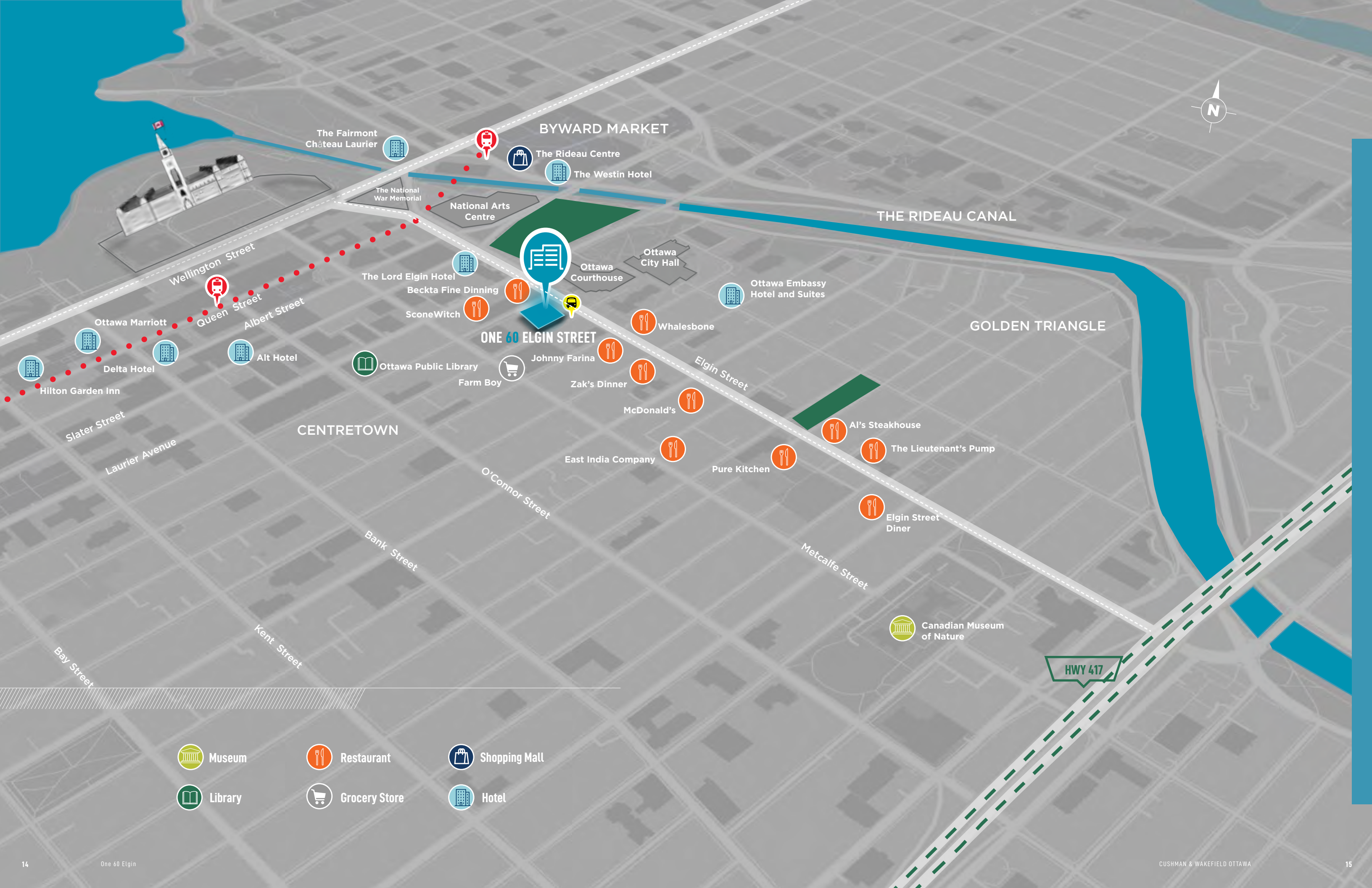

BYWARD MARKET

- The Fairmont Château Laurier
- The Rideau Centre
- The Westin Hotel
- The National War Memorial

THE RIDEAU CANAL

GOLDEN TRIANGLE

ONE 60 ELGIN STREET

CENTRETOWN

- Wellington Street
- Queen Street
- Albert Street
- Ottawa Marriott
- Delta Hotel
- Hilton Garden Inn
- Slater Street
- Laurier Avenue
- Bank Street
- Kent Street
- Bay Street

- National Arts Centre
- Ottawa Courthouse
- Ottawa City Hall
- The Lord Elgin Hotel
- Beckta Fine Dining
- SconeWitch
- Ottawa Public Library
- Farm Boy
- Johnny Farina
- Zak's Dinner
- McDonald's
- East India Company
- Whalesbone
- Pure Kitchen
- Elgin Street Diner
- Al's Steakhouse
- The Lieutenant's Pump
- Ottawa Embassy Hotel and Suites
- Canadian Museum of Nature

- Museum
- Library
- Restaurant
- Grocery Store
- Shopping Mall
- Hotel



AMENITIES



A/ Cuisine Club
 B/ Brown's Social Club
 C/ Bridgehead
 D/E/F/G Fitness Facility



ONE 60

ELGIN STREET

FOR MORE INFORMATION ON THIS OPPORTUNITY, CONTACT:

Kimberley Hall
Vice President
613 780 1585
khall@cwottawa.com



Cushman & Wakefield Ottawa, Brokerage
55 Metcalfe Street, Suite 400
Ottawa, ON K1P 6L5
cwottawa.com

©2021 Cushman & Wakefield Ottawa, Brokerage Independently Owned and Operated. All rights reserved. The information contained in this communication is strictly confidential. This information has been obtained from sources believed to be reliable but has not been verified. NO WARRANTY OR REPRESENTATION, EXPRESS OR IMPLIED, IS MADE AS TO THE CONDITION OF THE PROPERTY (OR PROPERTIES) REFERENCED HEREIN OR AS TO THE ACCURACY OR COMPLETENESS OF THE INFORMATION CONTAINED HEREIN, AND SAME IS SUBMITTED SUBJECT TO ERRORS, OMISSIONS, CHANGE OF PRICE, RENTAL OR OTHER CONDITIONS, WITHDRAWAL WITHOUT NOTICE, AND TO ANY SPECIAL LISTING CONDITIONS IMPOSED BY THE PROPERTY OWNER(S). ANY PROJECTIONS, OPINIONS OR ESTIMATES ARE SUBJECT TO UNCERTAINTY AND DO NOT SIGNIFY CURRENT OR FUTURE PROPERTY PERFORMANCE.